



DAVINCI TECHNICAL DATA GUIDE

# AUTOMATIC CONTROL VALVES

## AIR RELEASE VALVES

Ref. 171A-YUH / PN 25-40



### Application

Clean and pre-treated water  
Fire protection systems  
Irrigation networks  
Cooling water circuits  
HVAC Installations

### Approvals/Standards

Mounting flange: PN25/40 EN 1092-2, ISO 7005-2.  
Pressure Tests acc. to EN 12266-1 Rate A. GB/T13927-1992  
Pressure Tests: Seat: 1,1 x PN.

### Certifications

CE, WRAS

### Range

DN50-300, PN25-40





## GENERAL CHARACTERISTICS

Sizes DN50 to DN300.  
 Tripple function.  
 Full bore.  
 Blow shut pressure can come up to 2.0 bar.  
 Single body design to prevent breakage of dual bodies connection.  
 AISI 304 internals to prevent rusting.

## WORKING CONDITIONS

Pressure ratings: Up to 2.5 Mpa, 4.0 Mpa.\*  
 Working temperature: -10°C + 80°C.  
 Flow media: Clean water.

\* 6.3 Mpa and 10 Mpa available under request.

Nº	ITEM	MATERIAL
1	Dust cover	ASTM A106 Gr. B *
2	Bolts	A2
3	Cover	WCB *
4	Gasket	EPDM
5	Washer	PTFE
6	Board Gasket	AISI 304
7	Cage	AISI 304
8	Float	AISI 304
9	Body	WCB *
	RAL 5015 Painting	Epoxy 250 µm

\* Other materials like CF8 available under request.

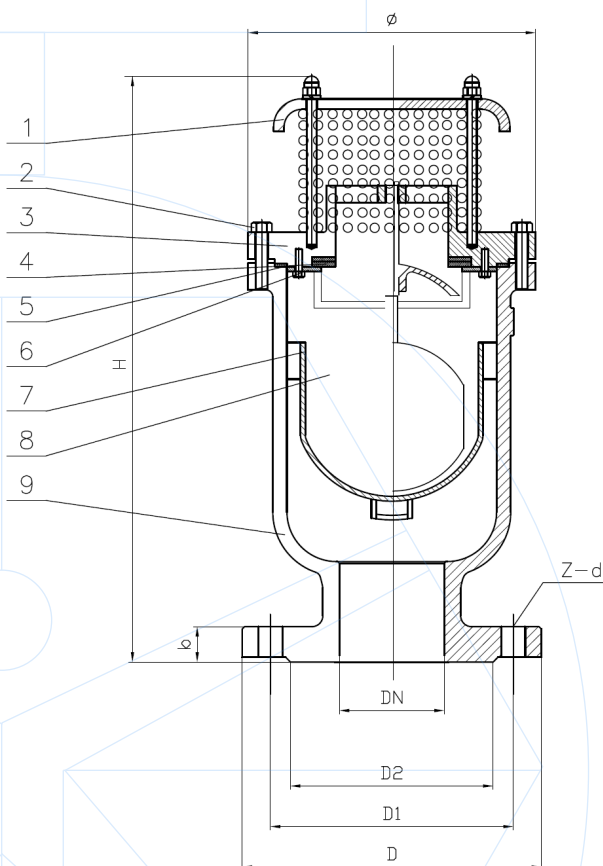

Components may be replaced with materials of equivalent or superior grade without prior notice, in accordance with our continuous improvement policy.

DN	D		D1		D2		b		H	Ø	Z-d	
	PN25	PN40	PN25	PN40	PN25	PN40	PN25	PN40			PN25	PN40
50	165		125		100		20		430	225	4-18	
80	200		160		135		24		460	265	8-18	
100	235		190		160		24		520	285	8-22	
150	300		250		218		28		620	350	8-26	
200	360	375	310	320	274	284	30	34	680	425	12-26	12-30
250	425	450	370	385	330	345	32	38	700	460	12-30	12-33
300	485	515	430	450	389	410	34	42	825	650	16-30	16-33



## INLET AND OUTLET FLOW CHART

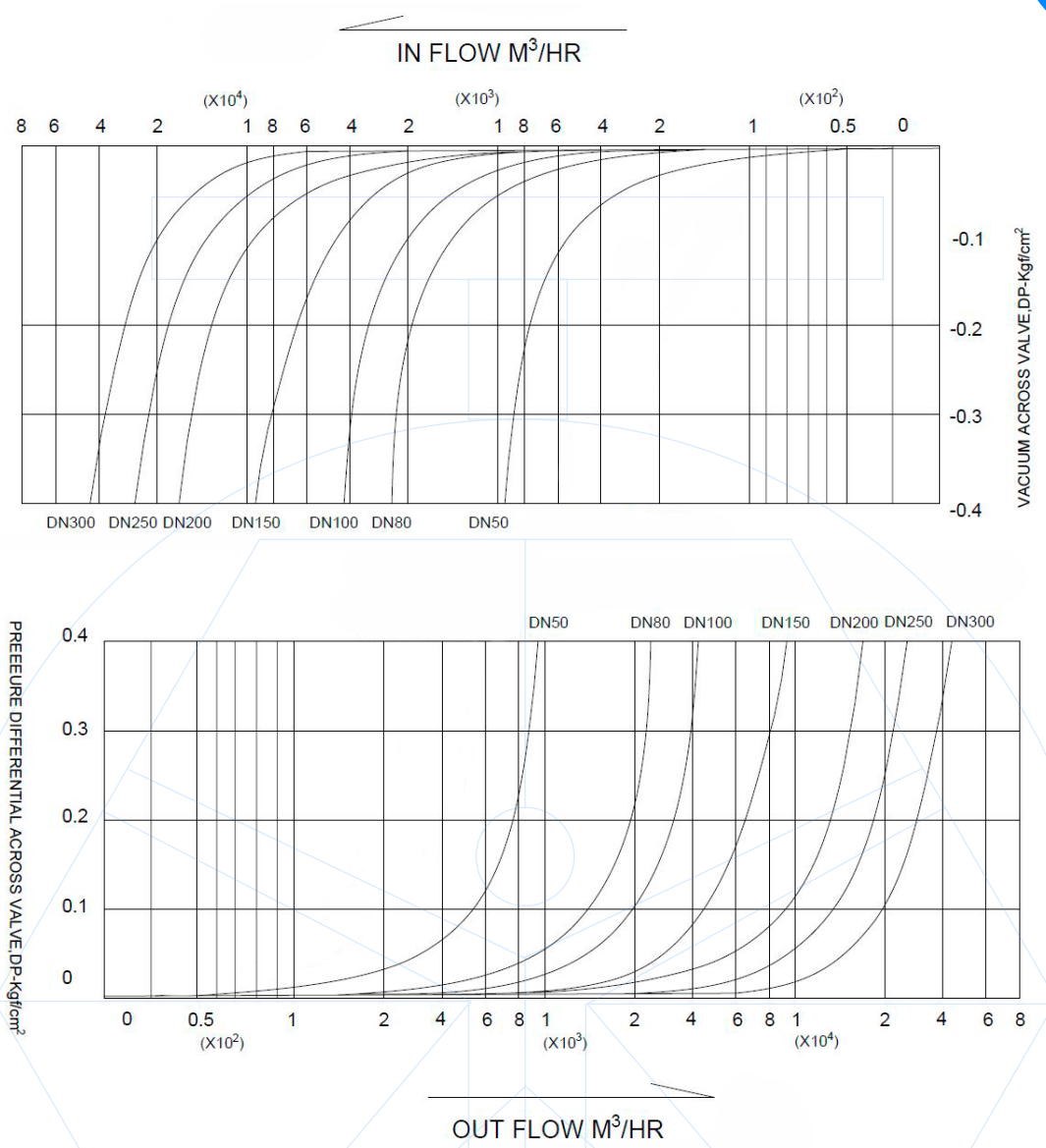

## AIR VENTING CAPACITY

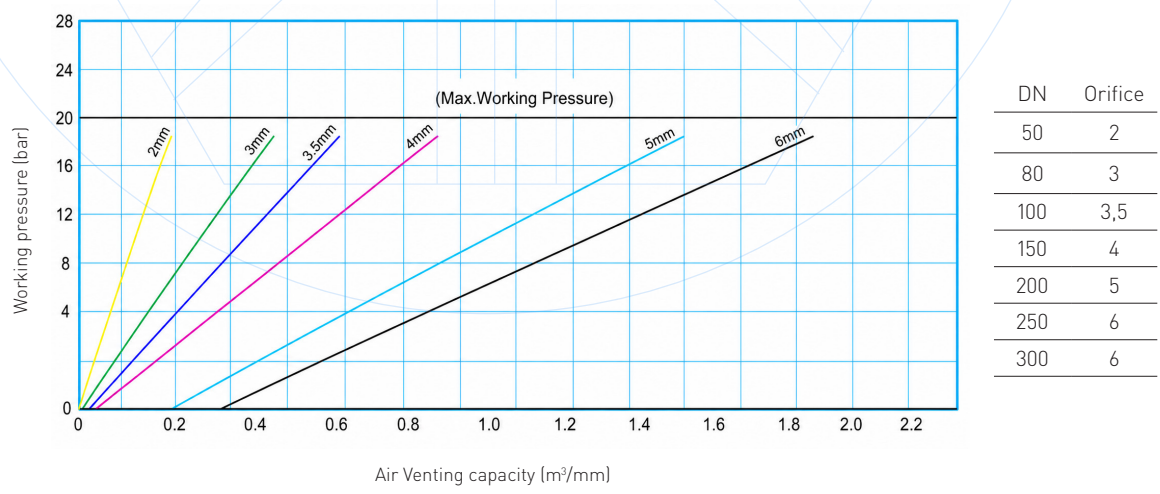



CONTACT US

# DAVINCI VALVES ORDER REQUEST

Ref. 171A-YUH / PN 25/40



## Head Office CHENGDU

Room 3208 Unit 1 Building 1,  
No. 6 Zhiquan Section, Dongda Street  
Jinjiang District, Chengdu, Sichuan  
CHINA

+86 17340168233 +86 19302892712  
valves@davincivalves.com

Europe Office MADRID  
SPAIN  
zuzana@davincivalves.com

## WEBSITE

davincivalves.com

YOUR QUALITY WATER PROJECTS PARTNER  
For professionals who look for more.